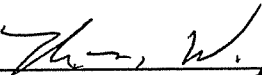

Legal Description
District 9

A parcel of land being located in the southwest one-quarter of Section 15, Township 4 South, Range 65 West of the Sixth Principal Meridian, City of Aurora, County of Arapahoe, State of Colorado being more particularly described as follows:

Beginning at the southwest corner of said Section 15, whence the west one-quarter corner of said Section 15 bears North 00°31'47" West a distance of 2625.14 feet, said line forming the basis of bearings for this description;
Thence North 00°31'47" West along the west line of said southwest one-quarter of Section 15 a distance of 1312.57 feet;
Thence North 89°16'54" East a distance of 987.91 feet;
Thence South 00°31'47" East a distance of 1315.39 feet;
Thence South 89°26'43" West along the south line of said southwest one-quarter of Section 15 a distance of 987.90 feet to the **Point of Beginning**.

Said parcel of land contains 1,298,088 square feet or 29.800 acres.

Thomas W. Case
For and on behalf of
Psomas
5990 Greenwood Plaza Bldg
Building 2, Suite 250
Greenwood Village, CO 80111
720.493.2920

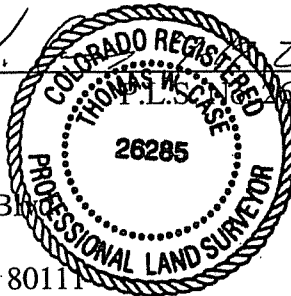

EXHIBIT

DISTRICT NINE BOUNDARY

WEST ONE-QUARTER CORNER
SEC.15, T4S, R65W, 6th PM

BASIS OF BEARINGS
WEST LINE OF THE SW 1/4
N 00°31'47" W 2625.14'



Scale: 1"=300'

N 89°16'54" E 987.91'

N 00°31'47" W 1312.57'

S 00°31'47" E 1315.39'

SOUTHWEST
ONE-QUARTER
SECTION 15
T4S, R65W, 6TH PM

29.800 ACRES

POINT OF BEGINING
SOUTHWEST CORNER
SEC.15, T4S, R65W, 6th PM

SOUTH LINE OF THE SW 1/4
S 89°26'43" W 2627.94'

S 89°26'43" W 987.90'

SOUTH ONE-QUARTER CORNER
SEC.15, T4S, R65W, 6th PM

PSOMAS

5990 Greenwood Plaza Blvd., Suite 250
Greenwood Village, CO 80111
(720) 493-2920 Fax: (720) 493-8112

THIS EXHIBIT DOES NOT REPRESENT
A MONUMENTED SURVEY. IT IS ONLY
INTENDED TO DEPICT THE ATTACHED
DESCRIPTION.